



**SIGNATURE
HUB**



*L*UXURY LIFE STYLE IN YOUR LIFE.....!



FALAKNAZ
COMMERCIAL HUB



INTRODUCTION

Welcome to Signature Hub, an exclusive residential and commercial Project, Located in the heart of Falaknaz Commercial Hub, Signature Hub is designed to offer a modern lifestyle and smart investment opportunities.

This Ground-Plus-Seven project includes apartments and shops with premium features, flexible payments plan, and an ideal location that ensures convenience and growth potential for residents and investors.





WHY CHOOSE SIGNATURE HUB?

Prime Location at Falak Commercial Hub

- Signature Hub is strategically located with direct access to KN Academy Road.
- Surrounded by 60-foot and 70-foot Wide Roads, ensuring smooth connectivity and easy access to nearby amenities.
- Situated in a thriving commercial and residential area that enhances your property's value over time.





RESIDENTIAL APARTMENTS & COMMERCIAL SHOPS



Whether you're looking for a cozy apartment or a prime commercial space, Signature Hub has it all:



APARTMENTS: Thoughtfully designed for modern living.



SHOPS: Perfect for entrepreneurs seeking high-visibility spaces in a bustling commercial area.

AMENITIES

At Signature Hub, every detail is designed to provide comfort, convenience, and security:



CCTV

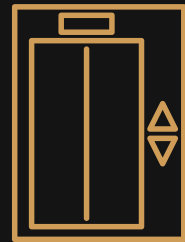

ELEVATOR



OPEN GYM



PLAY AREA



PUBLIC
RESTROOMS



WIDE ROADS

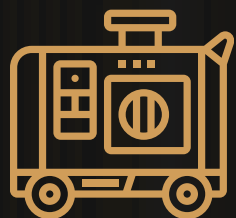

STAND-BY
GENERATOR



BASEMENT
PARKING



PRAYER AREA



ROOF-TOP
GARDEN



SWEET WATER



GATED
COMMUNITY



NEAR BY PLACES



600 Meter

KARCHI PUBLIC SCHOOL



700 Meter

BEACON ASKARI SCHOOL



SIGNATURE HUB



1.3 KM

KN ACADEMY

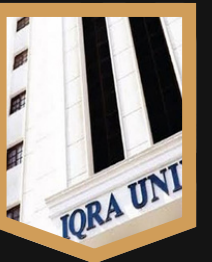

1.6 KM

IQRA UNIVERSITY

2.9 KM



MALIR EXPRESS WAY

3.4 KM



ASKARI 6

3.7 KM



MALIR CANTT

6.6 KM



M9 MOTOR WAY

9.5 KM



AIRPORT



APARTMENTS:

2 BED D/D (A):

- TYPE A1 (980 sq.ft)
- Type A2 (967 sq.ft)
- Type A3 (846 sq.ft)
- Type A4 (837 sq.ft)

2 Bed Lounge (B):

- TYPE B1 (786 sq.ft)
- TYPE B2 (780 sq.ft)

1 Bed Lounge (C):

- Type C (510 sq.ft)

✓ Luxury Size Bedrooms

✓ Bathroom

✓ American Kitchen

✓ TV Lounge

✓ Terrace

✓ Drawing Room



**SIGNATURE
HUB**

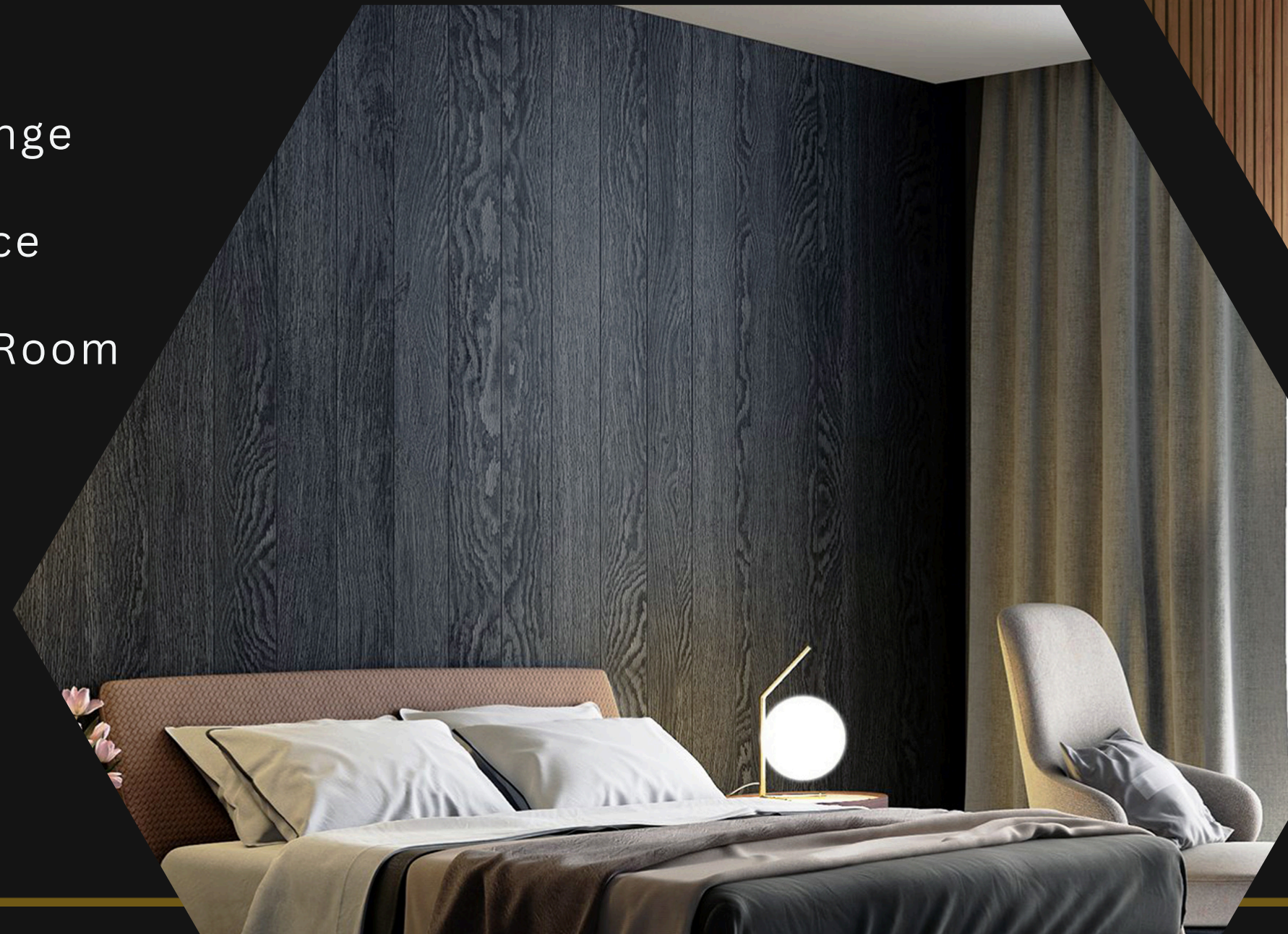

TYPE A



A1

A2

A3

A4

TYPE B

B1

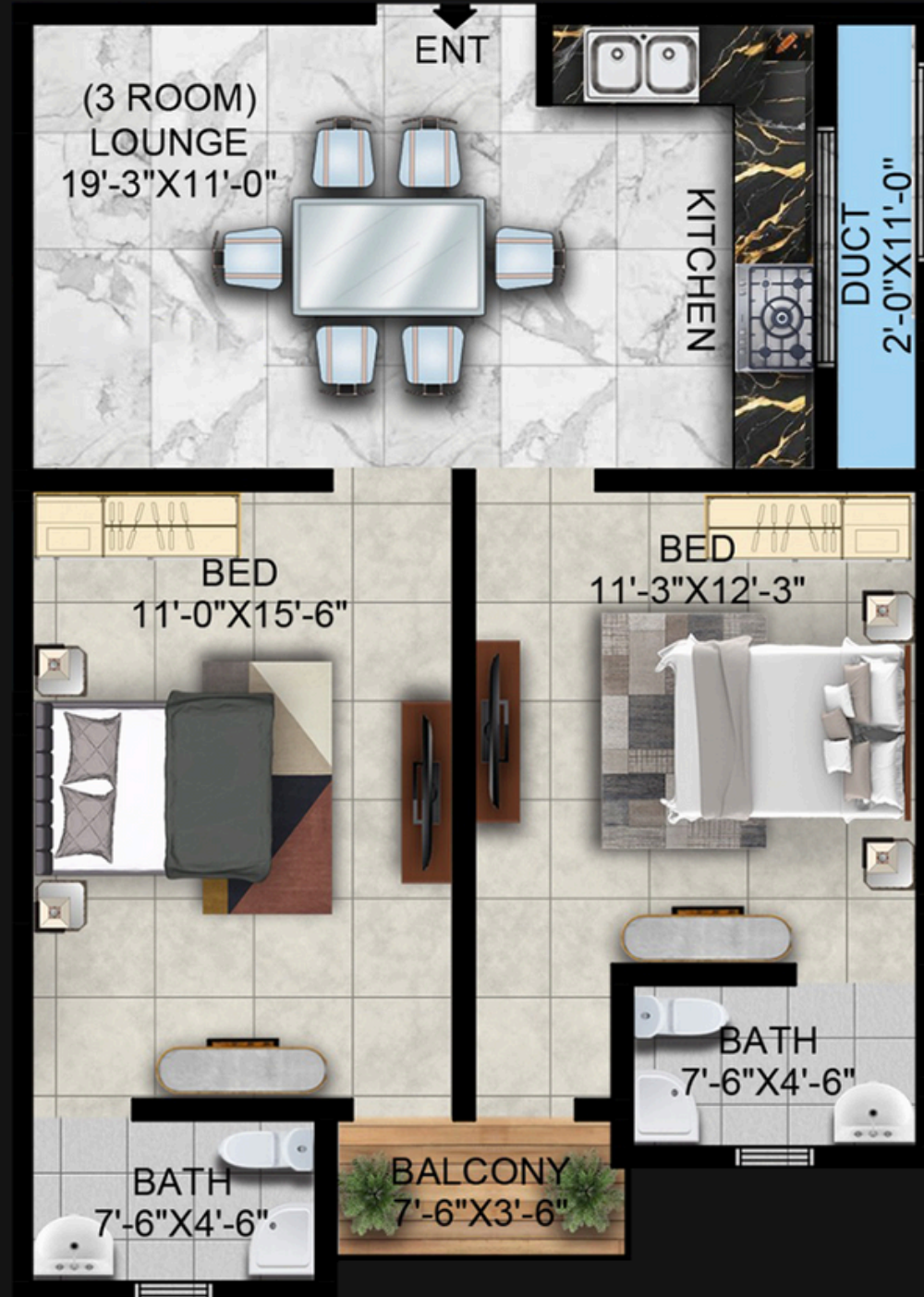

B2





FLEXIBLE PAYMENT PLANS



AFFORDABLE FOR EVERYONE

Investing in Signature Hub is easy and stress-free with our
4-year flexible payment plan

- **Booking Discount: Start with just 5% of the total price as your initial payment.**
- **Customized Payment Term: Spread your remaining balance over 48 months for an affordable monthly payment.**

This plan makes it easier for you to manage client budget while enjoying our services/products



INVEST TODAY FOR A **BRIGHTER TOMORROW**

Don't miss this once-in-a-lifetime opportunity to own a property in Signature Hub – a project that promises unmatched value, modern amenities, and long-term growth potential.

Contact Us:

0300 1111 990

Signature Hub – Redefining Lifestyle and Investment Opportunities at **Falak Commercial Hub!**